

# 3690

RESIDENTIAL STEEL  
COLLECTION

Ranch  
Panel



**Traditional Raised Ranch  
Panel Insulated Sandwich  
Residential Garage Door**

2" thick insulated sandwich panel constructed of top quality materials, highly detailed raised ranch panel embossment, deep woodgrain texture and two coat prefinished paint system all combine to enhance the beauty of your home.

**MODELS**

**3690 Insulated - R value: 10.25**

**doorLink**  
Manufacturing, Inc.®



# 3690 RESIDENTIAL STEEL COLLECTION

Ranch Panel

## Features:

- **Sandwich type construction** with CFC free expanded polystyrene insulation pressure bonded between two sheets of 26 gauge hot dipped galvanized steel with a 10.25 R value.
- **1.0 mil paint system** includes .25 mil rust inhibiting primer and .75 mil exterior top coat that resists fading and chalking while providing consistent color from panel to panel.
- **20 gauge** hot dipped galvanized steel hinge plates run the full height of each section at all hinge locations to facilitate the attachment of hinges, handles, struts and step plates.
- **Rigid aluminum retainer** provides added strength while securing replaceable U-shaped bottom weatherstrip.
- Sections include **tongue and groove** meeting rails for superior strength and better sealing against wind, rain and snow.

#306 Sherwood



#305 Williamsburg



#591 Cascade



#397 Stockton



#597 Stockbridge

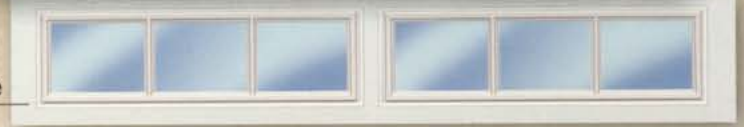

Not all glazing options may be available from all distributors.

## Cut-away view:

- Tongue and groove meeting rails.
- CFC free expanded polystyrene insulation.
- 20 gauge hot dipped galvanized steel hinge plates.
- Rigid aluminum retainer

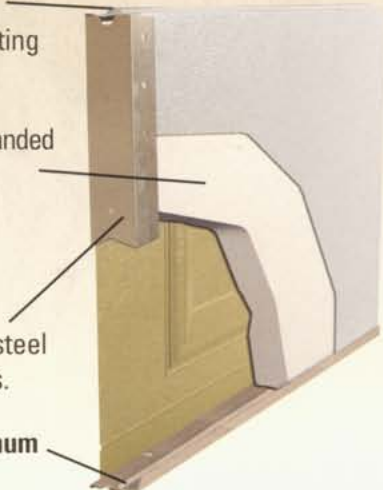

## Sizes Available:

HEIGHTS AVAILABLE:

DOOR WIDTH	PANELS WIDE		HEIGHTS AVAILABLE: 6'6", 6'9", 7'0", 7'6", 7'9", 8'0"			
8', 9'	<input type="checkbox"/>	<input type="checkbox"/>				
10'	<input type="checkbox"/>	<input type="checkbox"/>				
12', 14'	<input type="checkbox"/>	<input type="checkbox"/>	<input type="checkbox"/>			
15', 16', 17', 18'	<input type="checkbox"/>	<input type="checkbox"/>	<input type="checkbox"/>	<input type="checkbox"/>		
20'	<input type="checkbox"/>	<input type="checkbox"/>	<input type="checkbox"/>	<input type="checkbox"/>	<input type="checkbox"/>	

## Authorized Dealer:

## Colors Available:



Brochure color may vary from actual product.

**doorLink**  
Manufacturing, Inc.®